

 **YAMAHA**
Make Waves



PORTABLE PA SYSTEM

STAGEPAS 1K mkII

MORE PRACTICAL. MORE PROFESSIONAL. MORE POWERFUL.

What is it that makes one portable PA system stand out amongst the rest? Sound quality and output power? Flexible yet simple operation? Portability? Definitely all of the above and MORE.

With the new STAGEPAS 1K mkII our primary focus was to design a complete sound system that delivers professional quality sound despite a very simple setup and operation process that allows users to focus on what matters most – their performance.

Leveraging our extensive experience and accrued knowledge as a musical instrument manufacturer and audio technology pioneer, the STAGEPAS series has made it possible for users to create their own high-quality, high-output sonic environment that combines a lightweight, portable cabinet design with a comprehensive digital mixer that can be set up virtually anywhere in a matter of minutes.

With a practical yet stylish design, improved output components, and an onboard digital mixer that is simpler than ever to operate, the STAGEPAS 1K mkII raises the bar for portable sound reinforcement, offering a new level of sound quality and reliability that will help you focus on, and even inspire your best performances.

PORTABLE PA SYSTEM

STAGEPAS 1K mkII

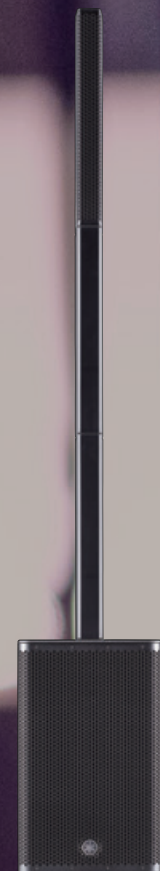

BEST-IN-CLASS COMPACT POWER

J-Curve Slim Line Array

The high-frequency speaker array is comprised of 10 small-diameter 1.5" speakers. By adopting a J-curve array configuration, the high-frequency unit achieves vertical coverage of 30 ° across a span of 170 °. With such a long, 10-driver array design the STAGEPAS 1K mkII can deliver clear, high quality sound consistently over longer distances, projecting uniform, high-quality sound from the front to the rear of the audience.



Class-leading 12-inch “compact” subwoofer

Despite housing a 12-inch speaker unit that is the largest in its class, the STAGEPAS 1K mkII boasts the smallest cabinet on the market for a subwoofer of this size and power.

By incorporating Yamaha’s own Twisted Flare Port™ technology to reduce port wind noise that can occur with compact bass-reflex subwoofers, the low-end output is maximized, producing very deep, powerful, distortion-free bass.



1100W amplifier

Also at the top of its class for output power, the 1100W Class-D amplifier module is capable of delivering an impressive 125 dB SPL from the deceptively compact speaker cabinet. And just as importantly, we’ve leveraged Yamaha’s decades-long experience as a manufacturer of professional PA products, and innovator of related technologies to ensure that with great power comes great stability, and that the STAGEPAS 1K mkII maintains the same accurate, superior-quality sound even at high output.



**PROFESSIONAL
FLEXIBILITY.
STRESS-FREE
OPERATION.**

Digital mixer with versatile input

With outstanding flexibility for a PA system of this size, the 5-channel digital mixer features three channels of mono microphone/line inputs and stereo inputs, with two of the mono input channels equipped with Hi-Z connectivity for direct input of acoustic-electric guitars and other instruments. In addition to Phone and 1/8" mini jacks, the stereo connections support playback with Bluetooth devices as well as a wide range of input sources from instruments to CDs, PCs and smartphones.



Professional control with a single knob

STAGEPAS 1K mkII comes equipped with a wealth of sound shaping functions, including 1-knob EQ for optimized multi band EQ setting, industry standard SPX reverb, and the “Mode” control for master output compression settings that match various applications such as “Speech” or “Music.” Each of these functions can be set via a single knob, and have simplified many of the tough tasks like EQ and compression to get you great sound fast.



STAGEPAS Controller

With an all-new interface, STAGEPAS Controller is a dedicated remote control application for the STAGEPAS 1K mkII that allows users to adjust volume and 1-knob EQ or 4-band PEQ via Bluetooth during rehearsal or performance. You can also save the adjusted settings for certain songs or applications in order to shorten your setup process in the future and maintain consistency from one performance to the next, and even control the volume of multiple STAGEPAS 1K mkII units from within the application.

Additionally, STAGEPAS 1K mkII features a “Priority Ducker” can be turned on/off directly from the device.



* STAGEPAS Controller can be downloaded from Apple's App Store and Google Play at no charge. (Apple, iPhone and iPod are trademarks of Apple Inc., registered in the U.S and other countries. App Store is a service mark of Apple Inc. Android and Google Play are trademarks of Google Inc.)

SUPERIOR UTILITY AND PORTABILITY

Simple setup

Simply affix the 2 spacers and speaker unit into the subwoofer and setup is essentially done, with no cables, speaker stand, or additional gear required beyond the main unit. All you need is in the package.



Expandable STAGEPAS systems

Linking two STAGEPAS 1K mkII or a STAGEPAS 1K mkII with a DXL1K provides greater coverage area and increased output power for large-scale performances. Both stereo and mono playback are supported, and when set to mono, the inputs of the two linked units(*) can still be used.

- 2x STAGEPAS 1K mkII:
up to six mono inputs plus two stereo inputs
- STAGEPAS 1K mkII and DXL1K:
up to five mono inputs plus one stereo input



Fitted cover included

The STAGEPAS 1K mkII comes with its own cover which, in addition to protecting the unit, has pouches for both spacers and speaker array as well as additional storage for accessories to further streamline system setup and teardown.



Optional dolly (DL-SP1K)

An optional dedicated dolly allows for more convenient transportation — particularly useful for performers transporting additional gear and instruments. Featuring a simple, sturdy mechanism that locks down the speaker cover the lightweight dolly enables smooth, reliable transportation.

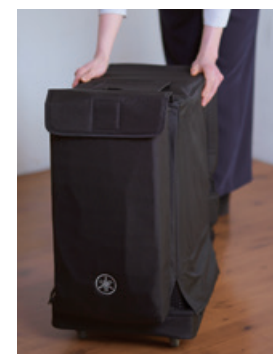

Application Examples

Mobile DJ

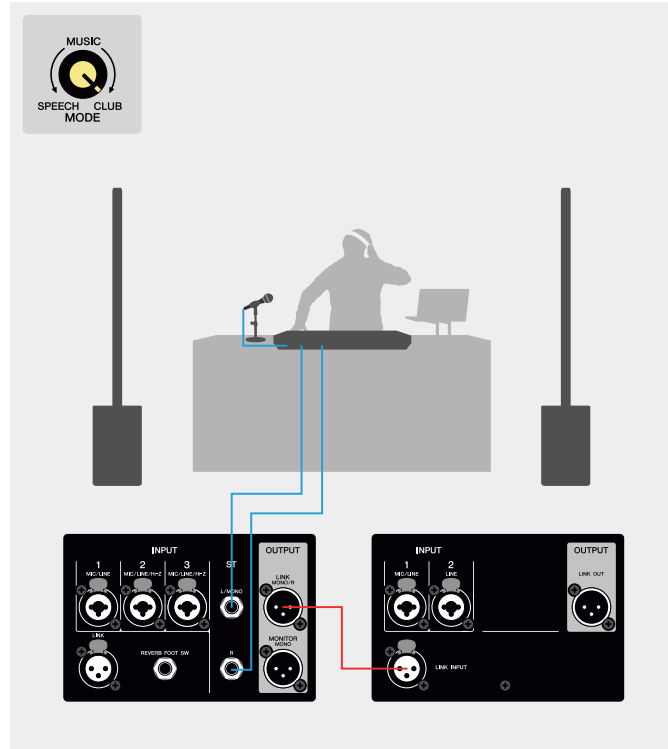

Guitar and vocals

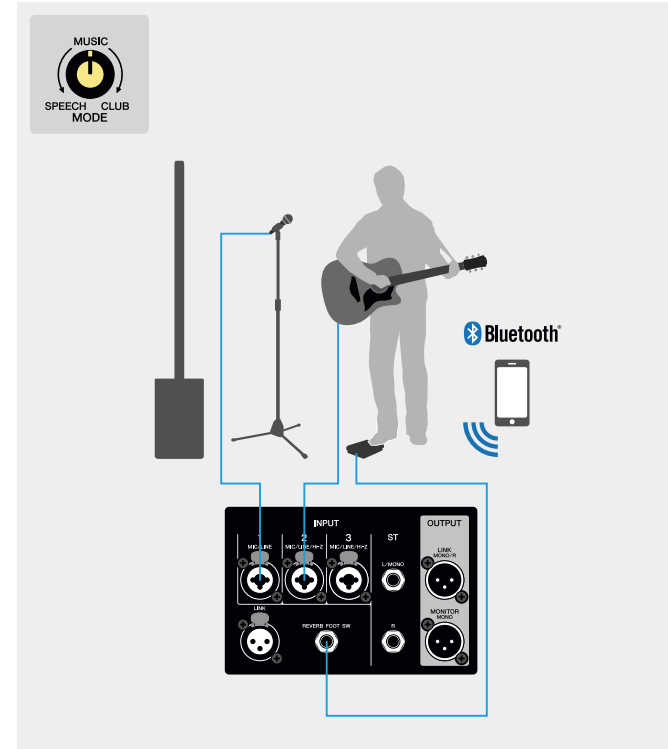

Ensemble performance

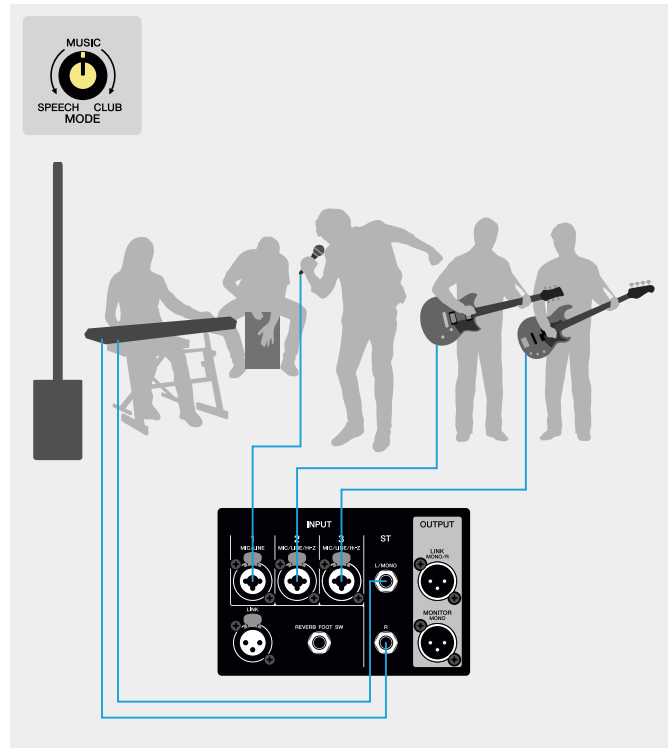

Public speaking

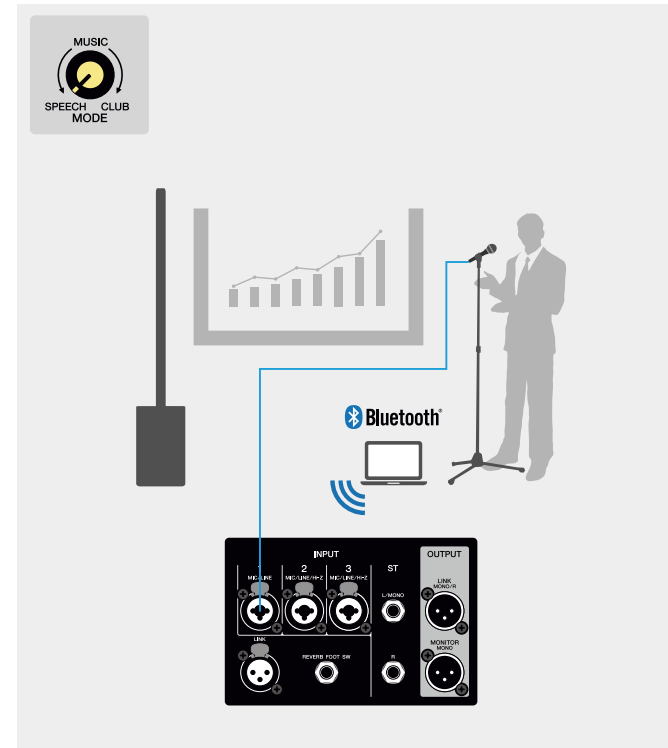

Specifications

Main Specifications	
System Type	Powered subwoofer with a line array speaker
Frequency Response (-10 dB)	37 Hz - 20 kHz
Coverage Angle (Horizontal x Vertical)	170° x 30°
Crossover Frequency	240 Hz
Maximum Output Level (Measured peak, IEC noise@1m)	125 dB SPL
Power Requirements	Depending on area of purchase: 100V 50Hz/60Hz, 110V-120V 60Hz, 220-240V 50/60Hz
Power Consumption	25 W (Idle), 91 W (1/8 power)
Dimensions (W x H x D)	System (maximum) 334 × 2,000 × 418 mm / 13.2" × 78.7" × 16.5"
Weight	23.0 kg (50.7 lbs)
Mixer section	
The number of Mixing Channels	5
Analog Inputs	Mono mic/line x 3 + mono line x 2, stereo line x1 LINK IN (MONO)
Bluetooth Audio Inputs	A2DP (SBC, AAC)
Content Protection Method	SCMS-T
Bluetooth Version	Ver 5.0
Transmission Frequencies	2,402-2,480MHz
Wireless Output	Class 1
Maximum Wireless Output Power (EIRP)	15dBm (32mW)
Channel Functions	Hi-Z switch : CH2/3
EQ / Effects	1-knob EQ : ALL channels MODE (SPEECH/MUSIC/CLUB) 4 types of reverb (HALL/PLATE/ROOM/ECHO) : CH1-3
Outputs	LINK OUT (MONO/R) MONITOR OUT (MONO)
External Controls	Reverb foot switch STAGEPAS Controller (iOS/Android app)
Amplifier section	
Type	Class-D
Rated Output	1100W
Speaker section	
Enclosure	Line array speaker : Enclosed Subwoofer : Bass-reflex type
Speaker Unit	Line array speaker : 1.5" (3.8 cm) Cone x10 Subwoofer : 12" (30 cm) Cone
Dimensions (W x H x D)	Line array speaker : 67 × 582 × 86 mm / 2.6" × 22.9" × 3.4" Spacer (each) : 67 × 555 × 86 mm / 2.6" × 21.9" × 3.4" Subwoofer : 334 × 550 × 418 mm / 13.2" × 21.7" × 16.5"
Weight	Line array speaker : 1.8 kg (4.0 lbs) Spacer (each) : 0.6 kg (1.3 lbs) Subwoofer : 20.0 kg (44.1 lbs)
Accessories	
Included in the package	Power cord, Cover, Owner's Manual
Optional accessories	DL-SP1K (dedicated dolly) / FC5 (foot switch for reverb ON/OFF)

Optional Accessories



DL-SP1K
Dedicated Dolly



FC5
Foot switch for reverb ON/OFF



STAGEPAS Controller
STAGEPAS 1K mkII's dedicated remote control application
iOS/Android compatible



YAMAHA CORPORATION
P.O.BOX1, Hamamatsu Japan

<http://www.yamahaproaudio.com/>

*All specifications are subject to change without notice.
*All trademark and registered trademarks are property of their respective owners.

*Please visit our Web site for the latest information
(<http://www.yamahaproaudio.com/>)



Yamaha Pro Audio
official Instagram



@yamaha_proaudio_official

